

Parts Manual  
PL71-61MF-911  
04/08/2011

# Cleco®

**61MF-910 Series**  
Non-Reversible Rotary Vane Power Motors



*For additional product information visit our website at <http://www.apextoolgroup.com>*



**Zampini Industrial Group**

**AirToolPro.com**

**1-800-353-4676**

Industrial Air & Electric Tools

We Sell Reliability!

In Business Since 1987

FREE Expert Assistance - Call Now

# Cleco® MOTOR UNITS 3/4" Dia. Keyed Output Spindle

61MFN911M  
61MFN912M  
61MFN913M  
61MFN914M  
61MFN915M

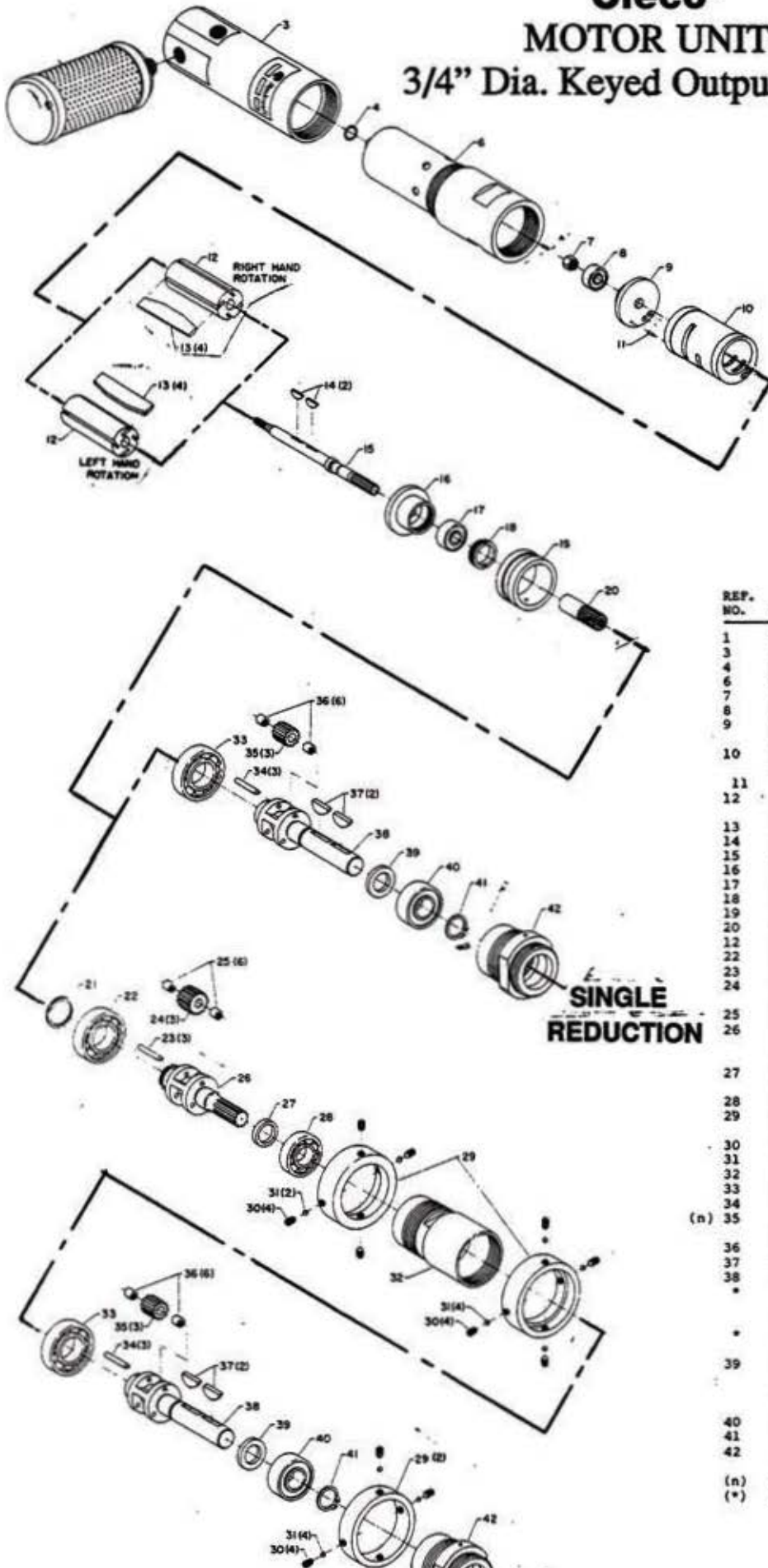

| REF. NO. | PART NO.       | DESCRIPTION   |
|----------|----------------|---|
| 1        | 1015870        | Muffler   |
| 3        | 1015620        | Rear Head   |
| 4        | 1010043        | O-Ring  |
| 6        | 1015616        | Motor Housing   |
| 7        | 1010134        | Hex Nut   |
| 8        | 1009017        | Ball Bearing  |
| 9        | 1008935        | Rear Plate (61MF Series)                              |
|          | 1009195        | Rear Plate (61ML Series)                              |
| 10       | 1008864        | Cylinder (61MF Series)                                |
|          | 1009191        | Cylinder (61ML Series)                                |
| 11       | 1013933        | Pin (Incl. in #10)                                    |
| 12       | 1008865        | Rotor (61MF Series)                                   |
|          | 1013622        | Rotor (61ML Series)                                   |
| 13       | 1008867        | (4) Rotor Blade                                       |
| 14       | 1001473        | (2) Woodruff Key                                      |
| 15       | 1009324        | Rotor Shaft   |
| 16       | 1009323        | Front Plate   |
| 17       | 1009015        | Ball Bearing  |
| 18       | 1004639        | Bearing Retainer                                      |
| 19       | 1009550        | Spacer  |
| 20       | 1015667        | Pinion (61MF/ML-911,13)                               |
| 21       | 1009530        | Retaining Ring (61MF/ML-913,14,15)                    |
| 22       | 1009333        | Ball Bearing (61MF/ML-913,14,15)                      |
| 23       | 1009331        | (3) Planet Pin (61MF/ML-913,14,15)                    |
| 24       | 1009594        | (3) Planet Gear (61MF/ML-913)                         |
|          | 1009332        | (3) Planet Gear (61MF/ML-914,15)                      |
| 25       | 1009303        | (6) Needle Bearing (61MF/ML-913,14,15)                |
| 26       | 1009601        | Planet Cage (61MF/ML-913)                             |
|          | 1009598        | Planet Cage (61MF/ML-914)                             |
|          | 1009599        | Planet Cage (61MF/ML-915)                             |
| 27       | 1009593        | Planet Cage Washer (61MF/ML-913)                      |
|          | 1009592        | Planet Cage Washer (61MF/ML-914,15)                   |
| 28       | 1005003        | Ball Bearing (61MF/ML-913,14,15)                      |
| 29       | 1016054        | Lock Collar (61MF/ML-913,14,15)                       |
|          | 1015665        | Lock Collar (61MF/ML-911,12)                          |
| 30       | 1008344        | Set Screw (61ML Series)                               |
| 31       | 1015675        | Pad (61ML Series)                                     |
| 32       | 1013858        | Internal Gear (61MF/ML-913,14,15)                     |
| 33       | 1009333        | Ball Bearing  |
| 34       | 1009331        | (3) Planet Pin  |
| (n) 35   | 1009594        | (3) Planet Gear (61MF/ML-911,13,14)                   |
|          | 1009332        | (3) Planet Gear (61MF/ML-912,15)                      |
| 36       | 1009303        | (6) Needle Bearing                                    |
| 37       | 1001311        | (2) Woodruff Key                                      |
| 38       | 1015643        | Planet Cage (61MF/ML-911,13,14), Incl:                |
| *        | 1015356        | Retaining Ring (61MF/ML-911,13,14)<br>Current Model   |
| *        | 1015644        | Planet Cage (61MF/ML-912,15), Incl:                   |
| *        | 1015357        | Retaining Ring (61MF/ML-912,15)<br>Current Model      |
| 39       | 1009593        | Planet Cage Washer (61MF/ML-911,13,14)<br>Early Model |
|          | 1009592        | Planet Cage Washer (61MF/ML-912,15)<br>Early Model    |
| 40       | 1010135        | Ball Bearing  |
| 41       | 1012796        | Retaining Ring  |
| 42       | 1015641        | Internal Gear   |
| (n)      | NEW PART       |   |
| (*)      | PART NOT SHOWN |   |

# SERVICE NOTES

| Catalog Number | Spindle Speed (rpm) | Spindle Rotation |
|----------------|---------------------|------------------|
| 61MFN911M      | 3,750               | Right Hand       |
| 61MFN912M      | 1,850               |                  |
| 61MFN913M      | 875                 |                  |
| 61MFN914M      | 450                 |                  |
| 61MFN915M      | 225                 |                  |

## FEATURES

Right Hand Rotation Motor (**61MF**)  
Left Hand Rotation Motor (**61ML**)  
3/4" Diameter Keyed Spindle  
3/4 horsepower

## POWER SOURCE

Requirements: 90-100 PSI air pressure,  
minimum 3/8" I.D. hose,  
air inlet thread size: 3/8" NPT



**Zampini Industrial Group**  
**AirToolPro.com**  
**1-800-353-4676**

Industrial Air & Electric Tools  
We Sell Reliability!  
In Business Since 1987  
FREE Expert Assistance - Call Now

**Cleco®**

**REVERSIBLE MOTOR UNITS**  
**3/4" Dia. Keyed Spindle**

**61MRR911M**  
**61MRR912M**  
**61MRR913M**  
**61MRR914M**  
**61MRR905M**

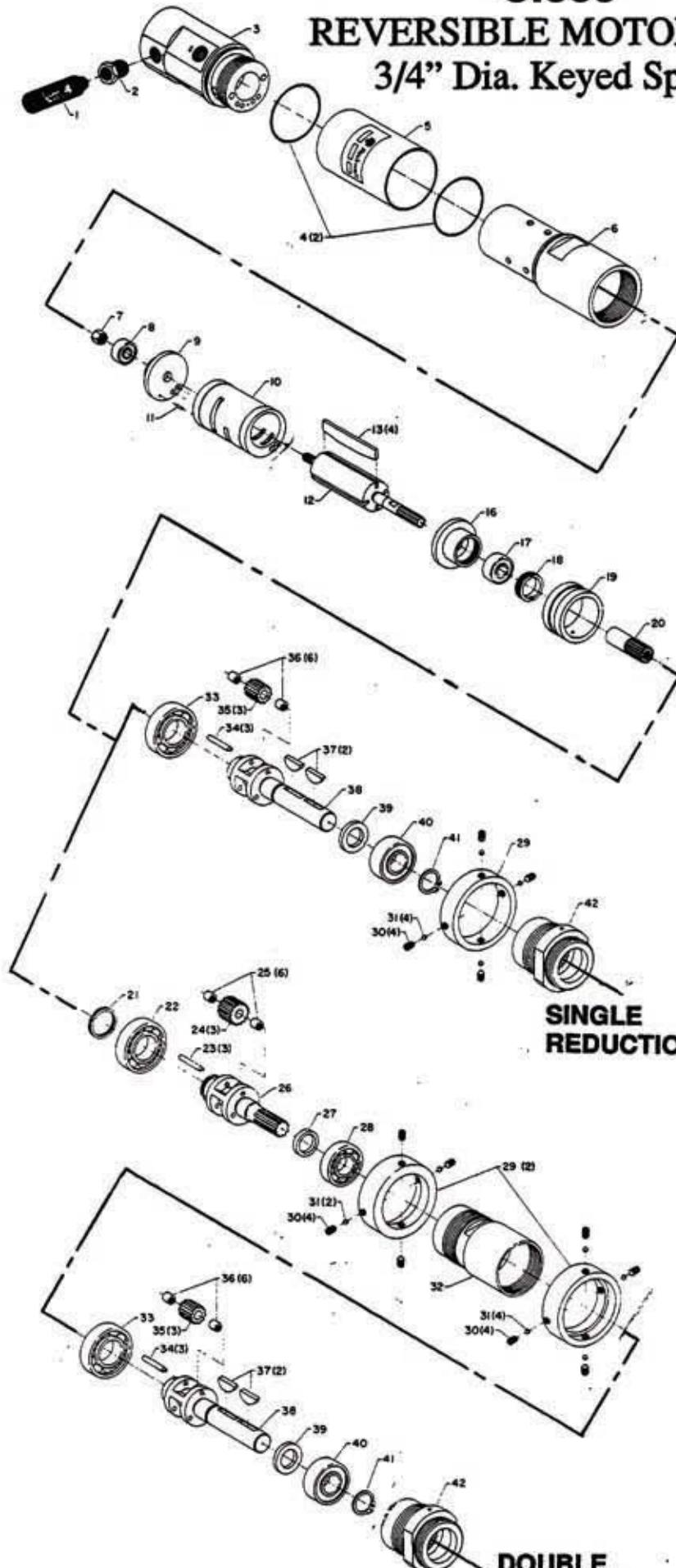

REF. NO. PART NO. DESCRIPTION

|     |         |                                     |
|-----|---------|-------------------------------------|
| 1   | 1015869 | Muffler                             |
| 2   | 1014706 | Bushing                             |
| 3   | 1015671 | Rear Head                           |
| 4   | 1010229 | O-Ring                              |
| 5   | 1015646 | Exhaust Sleeve                      |
| 6   | 1015670 | Motor Housing                       |
| 7   | 1008723 | Hex Nut                             |
| 8   | 1009017 | Ball Bearing                        |
| 9   | 1015645 | Rear Plate                          |
| 10  | 1023798 | Cylinder, Incl: #11                 |
| 11  | 1008265 | Pin                                 |
| 12  | 1017515 | Rotor                               |
| 13  | 1017514 | Rotor Blade                         |
| 16  | 1009323 | Front Plate                         |
| 17  | 1009015 | Ball Bearing                        |
| 18  | 1004639 | Bearing Retainer                    |
| 19  | 1009550 | Spacer                              |
| 20  | 1015667 | Pinion (61MR-911,13)                |
| 21  | 1009530 | Retaining Ring (61MR-913,14,15)     |
| 22  | 1009333 | Ball Bearing (61MR-913,14,15)       |
| 23  | 1009331 | Planet Pin (61MR-913,14,15)         |
| 24  | 1009594 | Planet Gear (61MR-913)              |
|     | 1009332 | Planet Gear (61MR-914,15)           |
| 25  | 1009303 | Needle Bearing (61MR-913,14,15)     |
| 26  | 1009601 | Planet Cage (61MR-913)              |
|     | 1009598 | Planet Cage (61MR-914)              |
|     | 1009599 | Planet Cage (61MR-915)              |
| 27  | 1009593 | Planet Cage Washer (61MR-913)       |
|     | 1009592 | Planet Cage Washer (61MR-914,15)    |
| 28  | 1005003 | Ball Bearing (61MR-913,14,15)       |
| 29  | 1016054 | Locking Collar (61MR-913,14,15)     |
|     | 1015665 | Locking Collar (61MR-911,12)        |
| 30  | 1008344 | Set Screw                           |
| 31  | 1015675 | Pad                                 |
| 32  | 1013858 | Internal Gear (61MR-913,14,15)      |
| 33  | 1009333 | Ball Bearing                        |
| 34  | 1009331 | Planet Pin                          |
| 35  | 1009594 | Planet Gear (61MR-911,13,14)        |
|     | 1009332 | Planet Gear (61MR-912,15)           |
| 36  | 1009303 | Needle Bearing                      |
| 37  | 1001311 | Woodruff Key                        |
| 38  | 1015643 | Planet Cage (61MR-911,13,14), Incl: |
| (n) | 1015356 | Retaining Ring (61MR-911,13,14)     |
|     |         | Current Model                       |
|     | 1015644 | Planet Cage (61MR-912,15), Incl:    |
| (n) | 1015357 | Retaining Ring (61MR-912,15)        |
|     |         | Current Model                       |
| 39  | 1009593 | Planet Cage Washer (61MR-911,13,14) |
|     |         | Early Model                         |
|     | 1009592 | Planet Cage Washer (61MR-912,15)    |
|     |         | Early Model                         |
| 40  | 1010135 | Ball Bearing                        |
| 41  | 1012796 | Retaining Ring                      |
| 42  | 1015641 | Internal Gear                       |
| (n) |         | NEW PART                            |
| (*) |         | PART NOT SHOWN                      |



**Zampini Industrial Group**

**AirToolPro.com**

**1-800-353-4676**

Industrial Air & Electric Tools

We Sell Reliability!

In Business Since 1987

FREE Expert Assistance - Call Now

# SERVICE NOTES

| Catalog Number | Spindle Speed (rpm) | Spindle Rotation |
|----------------|---------------------|------------------|
| 61MRR911M      | 3,400               | Reversible       |
| 61MRR912M      | 1,700               |                  |
| 61MRR913M      | 825                 |                  |
| 61MRR914M      | 400                 |                  |
| 61MRR905M      | 200                 |                  |

## FEATURES

Reversible Motor  
 3/4" Diameter Keyed Spindle  
 3/4 horsepower

## POWER SOURCE

Requirements: 90-100 PSI air pressure,  
 minimum 3/8" I.D. hose,  
 air inlet thread size: 3/8" NPT

## **TO CONVERT "A" MODELS TO "B" MODELS:**

### Remove

| Ref. No. | Part No. | Description      |
|----------|----------|------------------|
| 12       | 1012094  | Rotor            |
| 13       | 1009469  | (4) Rotor Blades |

### Add

| Ref. No. | Part No. | Description      |
|----------|----------|------------------|
| 12       | 1017515  | Rotor            |
| 13       | 1017514  | (4) Rotor Blades |





**Zampini Industrial Group**  
**AirToolPro.com**  
**1-800-353-4676**

Industrial Air & Electric Tools  
We Sell Reliability!  
In Business Since 1987  
FREE Expert Assistance - Call Now



**Zampini Industrial Group**  
**AirToolPro.com**  
**1-800-353-4676**

Industrial Air & Electric Tools  
We Sell Reliability!  
In Business Since 1987  
FREE Expert Assistance - Call Now

## Sales & Service Centers

**Note:** All locations may not service all products. Please contact the nearest Sales & Service Center for the appropriate facility to handle your service requirements.

Dallas, TX  
**Apex Tool Group  
Sales & Service Center**  
1470 Post & Paddock  
Grand Prairie, TX 75050  
Tel: 972-641-9563  
Fax: 972-641-9674

Detroit, MI  
**Apex Tool Group  
Sales & Service Center**  
2630 Superior Court  
Auburn Hills, MI 48326  
Tel: 248-391-3700  
Fax: 248-391-7824

Houston, TX  
**Apex Tool Group  
Sales & Service Center**  
6550 West Sam Houston  
Parkway North, Suite 200  
Houston, TX 77041  
Tel: 713-849-2364  
Fax: 713-849-2047

Lexington, SC  
**Apex Tool Group**  
670 Industrial Drive  
Lexington, SC 29072  
Tel: 800-845-5629  
Tel: 803-951-7544  
Fax: 803-358-7681

Los Angeles, CA  
**Apex Tool Group  
Sales & Service Center**  
15503 Blackburn Avenue  
Norwalk, CA 90650  
Tel: 562-623-4457  
Fax: 562-802-1718

Seattle, WA  
**Apex Tool Group  
Sales & Service Center**  
2865 152nd Avenue N.E.  
Redmond, WA 98052  
Tel: 425-497-0476  
Fax: 425-497-0496

York, PA  
**Apex Tool Group  
Sales & Service Center**  
3990 East Market Street  
York, PA 17402  
Tel: 717-755-2933  
Fax: 717-757-5063

Canada  
**Apex Tool Group  
Sales & Service Center**  
5925 McLaughlin Road  
Mississauga, Ont. L5R 1B8  
Canada  
Tel: 905-501-4785  
Fax: 905-501-4786

Germany  
Cooper Power Tools  
GmbH & Co. OHG  
a company of  
Apex Tool Group, LLC  
Industriestraße 1  
73463 Westhausen  
Germany  
Tel: +49 (0) 73 63 81 0  
Fax: +49 (0) 73 63 81 222

England  
Cooper Power Tools  
GmbH & Co. OHG  
a company of  
Apex Tool Group, LLC  
C/O Spline Gauges  
Piccadilly, Tamworth  
Staffordshire B78 2ER  
United Kingdom  
Tel: +44 1827 8741 28  
Fax: +44 1827 8741 28

France  
Cooper Power Tools SAS  
a company of  
Apex Tool Group, LLC  
25 rue Maurice Chevalier  
77330 Ozoir-La-Ferrière  
France  
Tel: +33 1 6443 2200  
Fax: +33 1 6443 1717

China  
Cooper (China) Co., Ltd.  
a company of  
Apex Tool Group, LLC  
955 Sheng Li Road,  
Heqing Pudong, Shanghai  
China 201201  
Tel: +86-21-28994176  
Fax: +86-21-51118446

Mexico  
Cooper Tools  
de México S.A. de C.V.  
a company of  
Apex Tool Group, LLC  
Vialidad El Pueblito #103  
Parque Industrial Querétaro  
Querétaro, QRO 76220  
Mexico  
Tel: +52 (442) 211-3800  
Fax: +52 (442) 103-0443

Brazil  
Cooper Tools Industrial Ltda.  
a company of  
Apex Tool Group, LLC  
Av. Liberdade, 4055  
Zona Industrial - Iporanga  
SP Brazil  
Tel: +55 15 2383929  
Fax: +55 15 2383260

Hungary  
Cooper Tools Hungaria Kft.  
a company of  
Apex Tool Group, LLC  
Berkenyefa sor 7  
Pf: 640  
9027 Győr  
Hungary  
Tel: +36 96 66 1383  
Fax: +36 96 66 1135

Apex Tool Group, LLC  
1000 Lufkin Road  
Apex, NC 27539  
Phone: 919-387-0099  
Fax: 919-387-2614  
www.apextoolgroup.com

# Cleco®